



WEYBRIDGE

BACKGROUND

A refurbishment of a high-end private residential property in Weybridge. As part of the refurbishment an alternative solution to the existing traditional swing door was required. The scale of the refurbishment allowed for several door solutions to be assessed.

THE CHALLENGE

A key requirement of the door solution was to provide a fire-rated door as well as a door solution that would minimise the space required to open the door into the room. The client also wanted a larger than standard door opening.

Typically, an installation dictates that the system is built into the studwork frame but in this installation the system needed to be installed (face-mounted) onto an existing brickwork wall.

THE SOLUTION

Portman Pocket Doors worked very closely with the customer and the installer to develop a suitable solution. A Portman Pocket Doors FD30 single was selected as the most suitable solution for the application. Portman Pocket Doors design engineers worked with the customer to develop a fabulous, fully compliant FD30 joinery door. In addition, Portman Pocket Doors also produced a bespoke door blank to accompany the system, to provide a stunning door system meeting all of the requirements of the client.

LOCATION
Weybridge

PRODUCT USED
Portman Pocket
Doors [FD30](#)



WEYBRIDGE

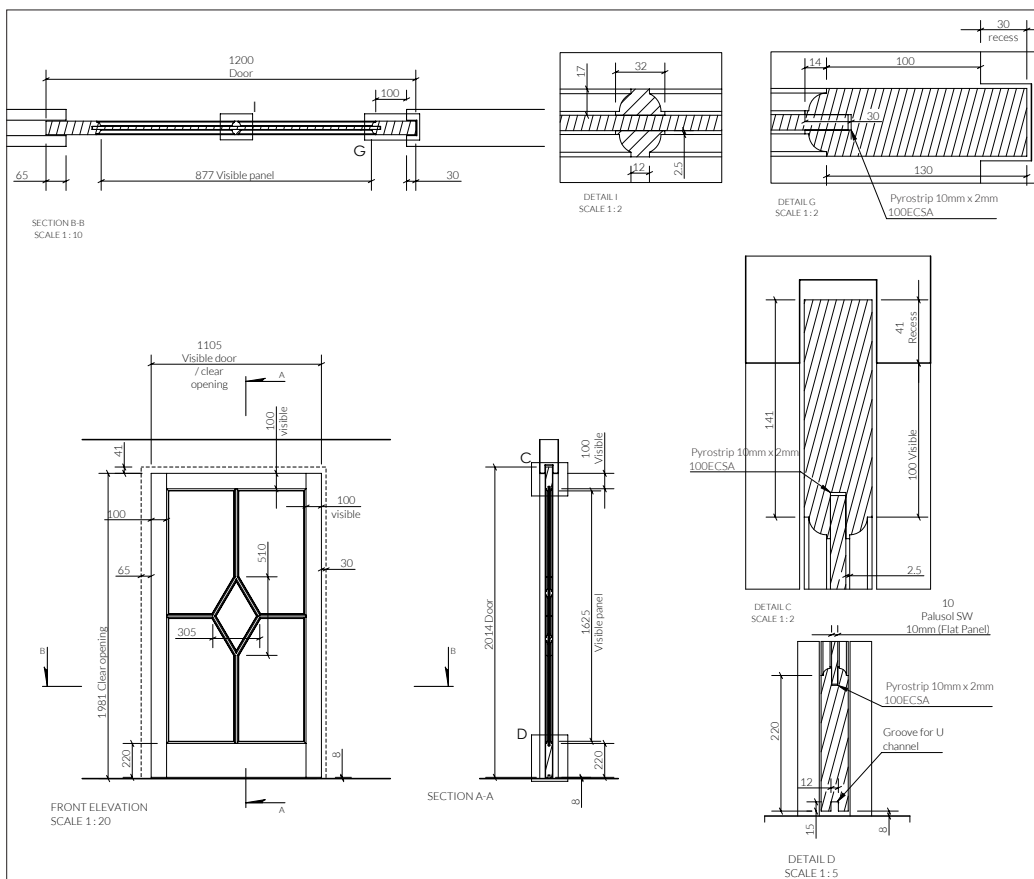

LOCATION
Weybridge

PRODUCT USED
Portman Pocket
Doors [FD30](#)